



## HECO IS REPLACING OUR MODEL 25 AND MODEL 35

The Model 25 is being replaced by the new optimized Model 30 design. The Model 35 is also being replaced by the new optimized Model 40 design.

Why the Change?

The Heco Gear Model 25 introduced in 2004 represented many upgrades in the internal design over its predecessor the Model 20. The model 35 was introduced in 2016 as a 4 planet version of the model 25 design offering higher torque capacity. The new Model 30/40 being introduced now represents a change to a completely new “optimized” gear profile from the Model 25/35 gearing. Heco Gear has been able to make these improvements without making alterations to the external dimensions. The Heco Gear Model 20, Model 25/35 and now Model 30/40 are all direct mounting interchange for each other. The new Model 30/40 have been in design and testing for the past year and has proven to provide a significant improvement in overall performance and operating life over the Model 25/35.

### Model 30 Vs. Model 25:

- The Model 30 is a direct interchange for the Model 25 and has the same external dimensions.
- The Model 30 uses a new “optimized” gear design achieved using the latest gear design software.
- The Model 30 & Model 25 are both 3 planet gear designs.
- The Model 30 will yield longer overall service life than the Model 25 at the same torque & speed.
- The Model 25 sun gears **cannot be used in the Model 30!** Model 30 sun gears are available to match the model 25 offering.

### Model 40 Vs. Model 35:

- The Model 40 offers more torque capacity than the Model 30 therefore longer life in the same application.
- The Model 40 is a direct interchange for the Model 35 and has the same external dimensions.
- The Model 40 uses the new “optimized” gear design of the Model 30 which was achieved using the latest gear design software.
- The Model 40 & Model 35 are both 4 planet gear designs.
- The Model 40 continues to use a hardened ring gear for wear capacity same as Model 35.
- The Model 40 will yield longer overall service life than the Model 35 at the same torque & speed
- The Model 35 sun gears **cannot be used in the Model 40!** Model 40 sun gears are available to match the model 35 offering.

It will be easy to identify the Model 30/40 design vs the Model 25/35 as they will have an annular groove machined on the outside of the ring gear section as shown (right).

The sun gear carton will have a label clearly indicating what to look for to make sure the customer does not mix up the 25 vs 30/40 sun gears.

Replacement parts will be available for many years to support the Model 25.

Distributors will have up to one year to return new Model 25 inventory for full credit.

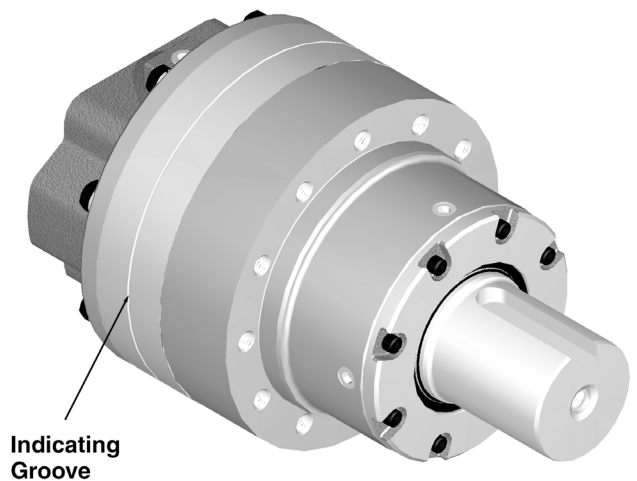

**IMPORTANT** – All previous specifications, data sheets and catalogs on both the Model 25 and Model 35 are obsolete effective 12/29/2021. Refer to the appropriate product specifications at [www.hecogear.com](http://www.hecogear.com).