

6 HOLES
3/4-10 UNC DN
11.00 DIA. B.C.

Flange and Shaft

Code	Description
50DCF	Model 50 Double Reduction Center Flange Mount
1	3.875" Straight Keyed Shaft Shaft

Performance Data

	Torque	in-lbs	ft-lbs	Nm
Continuous		140,000 in-lbs	11,665 ft-lbs	15,820 Nm
Intermittent		160,000 in-lbs	13,330 ft-lbs	18,080 Nm
Peak		180,000 in-lbs	15,000 ft-lbs	20,335 Nm
Radial Load				40,000 lbs
Approximate Weight				250 lbs
Maximum Speed	Ratio	Output rpm	Input rpm	
	31.2	75	2300	

* Maximum life in high torque applications will be achieved at lower output speeds. Conversely, maximum life in high speed applications will be achieved at lower output torques.

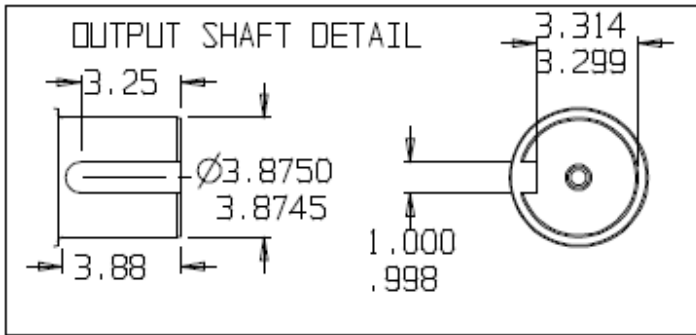

Motor Adapter Options

Code	Description
0	SAE B 4.00" Pilot 4 Bolt
4	SAE A 3.25" Pilot 2&4 Bolt
5	SAE B 4.00" Pilot 2 Bolt
6	SAE C 5.00" Pilot 2&4 Bolt

Ratio Options

Code	Description
31	31.2 : 1 Double Reduction

Order Information and Model Code

50DCF	1				
Flange	Shaft	Motor Adapter	Ratio	Design Code	Special Options

Sungear (Input Motor Shaft) Options

Code	Description
16-4000-H	1-1/4" Straight Keyed for Charlynn Standard 4000 Motor
16-4000-I	1-1/4" 14T Spline 12/24 DP for Charlynn Standard 4000 Motor
16B	7/8" 13T Spline 16/32 DP (1.40" to 1.75" shaft length)
16D	1" Straight Keyed (1.80" to 2.10" shaft length)
16H	1-1/4" Straight Keyed (2.05" to 2.40" shaft length)
16I	1-1/4" 14T Spline 12/24 DP (2.00" to 2.32" shaft length)
16M	1" SAE 6B Spline (1.95" to 2.30" shaft length)
16P	1-1/8" Keyed (1.85" to 2.15" shaft length)
16C	1" 15T Spline 16/32 DP (1.70" to 1.95" shaft length)
16E	Charlynn 2000 Bearingless
16O	7/8" Keyed (1.80" to 2.09" shaft length)
16F	Charlynn 4000 Bearingless
16S	Danfoss OMSS